

Data sheet

Support roller NATV 12 PP (crowned, with axial guidance, full needle, seal)

Designation	NATV 12 PP
Type	crowned
D [mm]	32
d [mm]	12
d1 [mm max.]	25
B1 [mm]	15
B [mm]	14
r [mm]	0,6
Dynamic load Crw[N]	9700
Static load C0rw[N]	15400
Speed limit [min-1]	3900
Speed limit [min-1]	6500

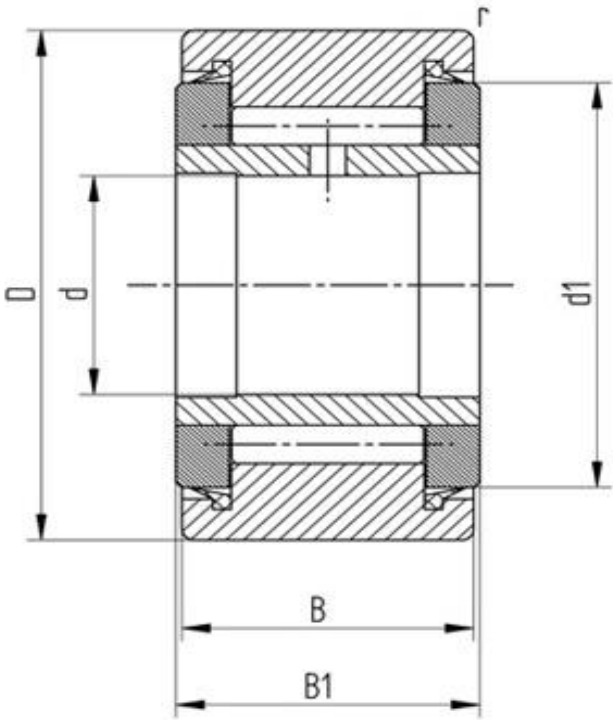

Every specification has been edited and verified carefully. STI Bearings GmbH assumes no liability for potential errors or incompleteness. Technical modifications are subject of changes.

© 2020 by STI Bearings GmbH
Reproduction, even excerpts, only with our approval.